

Recessed luminaire - Micro-prismatic diffuser - direct distribution

Sheet steel housing suitable for ceilings with visible T-rails, concealed symmetrical rail constructions and recessed ceilings; Housing colour traffic white RAL 9016; Light distribution direct distribution by means of Micro-prismatic diffuser of PMMA, a soft light is emitted on the outside with special ice-finish diffusers; light colour from warm white (927) to daylight white (965) with excellent colour consistency and colour rendering Ra>90. Suitable for VDU workstations, $65^\circ < 3000 \text{ cd/m}^2$ omnidirectional glare reduction in accordance with current DIN-EN 12464-1 standard, UGR (4H/8H) 18.9. Integrated DALI LED drivers device type 8 (DT8). Electrical connection via 5-pole connection terminal with plug-in contacts. TNE-BM mounting mechanism 4 pcs. 600/625 for concealed symmetrical rail constructions or recessed ceilings, please order separately. DALI control units must be ordered separately.

CHARACTERISTICS

Order number	50802416970
EAN number	4020863367276
Commodity code	94051190
Certification mark	IP 20, Protection class I, VDU $65^\circ < 3000$, F, F-"roof" mark, Indoor, CE
Impact resistance (IK rating)	IK02
Ambient temperatur	ta 25°C
Special properties	Ready for IoT
Warranty period	5 years

ELECTRICAL ENGINEERING

Controller	Electronic driver DALI device type 8 (1 pcs.)
System output	46W
Mains voltage	230V/50Hz
Circuit breakers (inrush current)	13 pieces/B10, 22 pieces/B16, 21 pieces/C10, 36 pieces/C16
Energy efficiency class/light source	E

LIGHTING TECHNOLOGY

Placement	LED, Colour rendering/Light colour CRI ≥ 90 / 2700K-6500K continuously adjustable
Colour tolerance (MacAdam)	3SDCM
Photobiological safety (Luminaire)	RG0
Nominal luminous flux	3950lm
LED service life	50000h L80/B10 (Tq 25°C)
Luminaire luminous efficiency	85lm/W
UGR lat./long.	18.5 / 18.9

MECHANICS

Housing colour	traffic white RAL 9016
Dimensions (LxWxH/DxH)	622mm x 622mm x 102mm
Depth	100mm
Ceiling system	Ceilings with visible T-rails [s-TS] (625x625 mm), Concealed symmetrical rail construction [VS] (625x625 mm), cut-out ceilings [AD]
Ceiling cut-out (LxW/D)	585mm x 591mm
Installation depth	120mm [AD]; 250mm [s-TS]; 120mm [VS]
Weight (net)	6.25kg
Type of installation	Recessed mounting, Ceiling installation individual mounting

DEEP-LINK

<https://www.regiolux.de/en/article/50802416970>

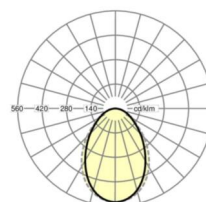

Reference	LED 4000lm 927-965
η_{LB}	100 %
$\Phi_{\downarrow/\uparrow}$	100 % / 0 %
UGR lat./long.	18.5 / 18.9
VDU	$65^\circ < 3000 \text{ cd/m}^2$

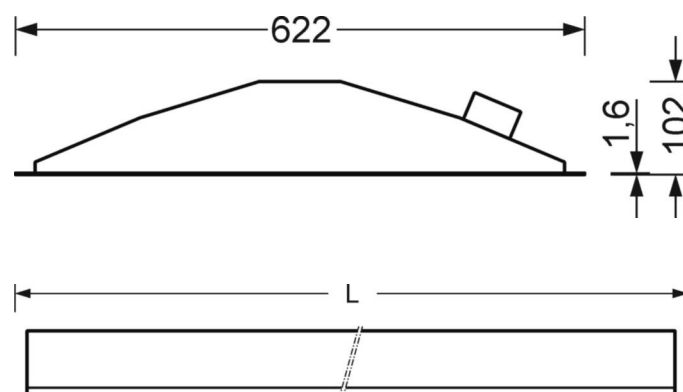

Dimensions

L	622 mm	Length
B	622 mm	Width
H	102 mm	Height
T	100 mm	Depth
DA(L)	585 mm	Cutting dimension length
DA(B)	591 mm	Cutting dimension width
Et(AD)	120 mm	Ceiling distance minimum (cut-out ceiling)
Et(TS)	250 mm	Ceiling distance minimum - recommended (visible T-rail)
Et(VS)	120 mm	Ceiling distance minimum (concealed symmetrical)
MLTS1	625 mm	Module dimension length (visible T-rail)
MLTS_1/2	625	Module dimension length (visible T-rail) 1/2
MLVS	625 mm	Module dimension length (concealed symmetrical)
MBTS1	625 mm	Module dimension width (visible T-rail)
MBTS_1/2	625	Module dimension width (visible T-rail) 1/2
MBVS	625 mm	Module dimension width (concealed symmetrical)
